



# SANTA FE CEILING HEPA



Ceiling HEPA Box



Mini



Standard

## PERFORMANCE

	Standard Ceiling HEPA Model 4042720	Mini Ceiling HEPA Model 40242660
Electrical	115V, 2.4A, 273W	115V, 1.5 A, 171W
Weight	45 lbs.	25 lbs.
Total System Airflow	>515 CFM @ 1.0 IWG	>275 CFM @ 1.0 IWG
HEPA Effectiveness	99.97% @ 0.3 um	99.97% @ 0.3 um
Clean Air Delivery	515 CFM	275 CFM
Sizing per ACH (8' ceiling)	2 ACH - 1,930 Sq. Ft. 4 ACH - 965 Sq. Ft.	2 ACH - 1,030 Sq. Ft. 4 ACH - 515 Sq. Ft.
Fan Box Dimensions*	26" x 22" x11.7"	17" x 14" x11.7"
Ceiling HEPA Box Dimensions Including the filter grille:	23.75" x 23.75" x 7.8" (without the duct collar) and x 9.7" (with the duct collar attached)	
Not including the filter grille:	20.7" x 20.6" x 6.8" (without the duct collar) and .87" (with the duct collar attached)	
Sound Rating		
No Drop Ceiling Install	55 dBA	55 dBA
Drop Ceiling Install	45-50 dBA	45-50 dBA

## SYSTEM COMPONENTS

1. Custom return filter enclosure with 10" collar
2. MERV-8 pre-filter: 20" x 20" x 1"
3. Gasketed HEPA filter: 18" x 18" x 2.5"
4. 25' of 10" R6 insulated ductwork (not included)
5. Supply air diffusers with 10" collar (not included)
6. Fan box w/ 6' cord

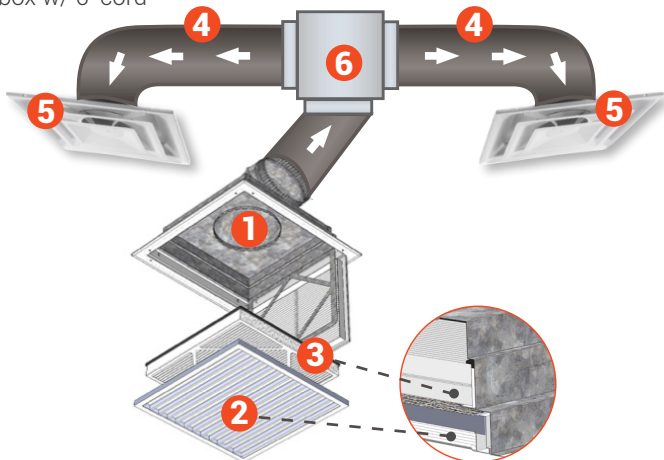

Specifications are subject to change without notice.  
\*Fan box dimensions are with ducts included.

## FEATURES

Innovative HEPA air filtration system designed for installation above drop ceilings that:

- + Runs independently to deliver an increased number of clean air changes per hour without interfering with HVAC system performance
- + Minimizes sound for occupants
- + Does not take up floor space like typical portable air cleaners
- + Delivers market leading clean air delivery per \$ of any installed filtration system
- + Distributed return and supply promotes better delivery of clean air and allows for different engineering strategies to be employed to protect occupants



**SANTA-FE™**  
INDOOR AIR QUALITY SOLUTIONS



**BUILT TO LAST. BUILT TO PERFORM.**

## ▶ INSTALLATION

### STEP 1

Unpackage all components and determine installation location on the ceiling. Supply and return should be a minimum of 6' apart and a maximum of 25'.

### STEP 2

Install supply diffusers and return filter box in the drop ceiling. Additional support may be required. Refer to T-bar ceiling manufacturer instructions.

### STEP 3

Install the fan box between the return and supply registers. The preferred installation is to suspend the fan from structural members.

### STEP 4

Install ductwork between system components.

### STEP 5

Plug fan in or wire fan per NEC and ensure proper operation and support for all components.



Return grill attached to filter assembly



Supply diffuser(s) that connect to fan assembly

## FILTER REMOVAL

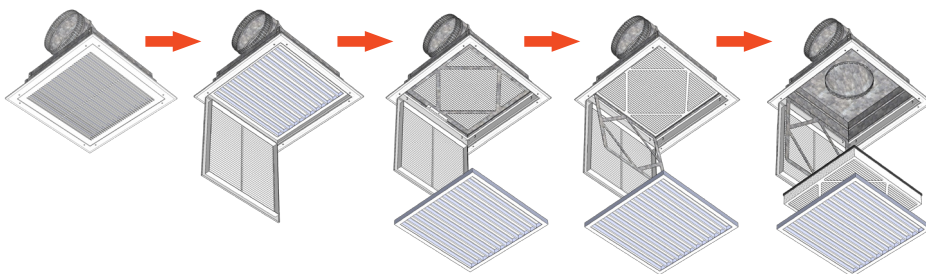

Unit design allows for easy removal of both the pre-filter and HEPA filter without the use of additional tools.

## ORDERING INFORMATION

### PART NO. ITEM

4031864	HEPA Filter, 18"x18"x2.5"
103-010	MERV-8 Pre-Filter, 20"x20"x1"
103-226	Filter Box
103-300	Fan Box (Standard)
103-400	Fan Box (Mini)

The Santa Fe team is available Monday - Friday, 8 am - 5 pm CT.

**We want to hear from you, so don't hesitate to reach out.**

Need help with a warranty claim? Contact us at 800-533-7533.

Contact Customer Service at [orders@santa-fe-products.com](mailto:orders@santa-fe-products.com).

**SANTA-FE-PRODUCTS.COM**